

# Alliance★California®

## GATEWAY SOUTH

### BUILDING 8

584 E NORMAN RD | SAN BERNARDINO, CA 92408

±300,188 SF Available

AllianceCalifornia, Hillwood's 2,000-acre trade and logistics center, is located in one of the top industrial markets in the nation and offers companies the most competitive space in southern California. The project features outstanding access to air, rail, and interstate highways. AllianceCalifornia is located at the intersection of the I-10, I-215 and I-210 freeways providing an excellent transportation network for prospective users.



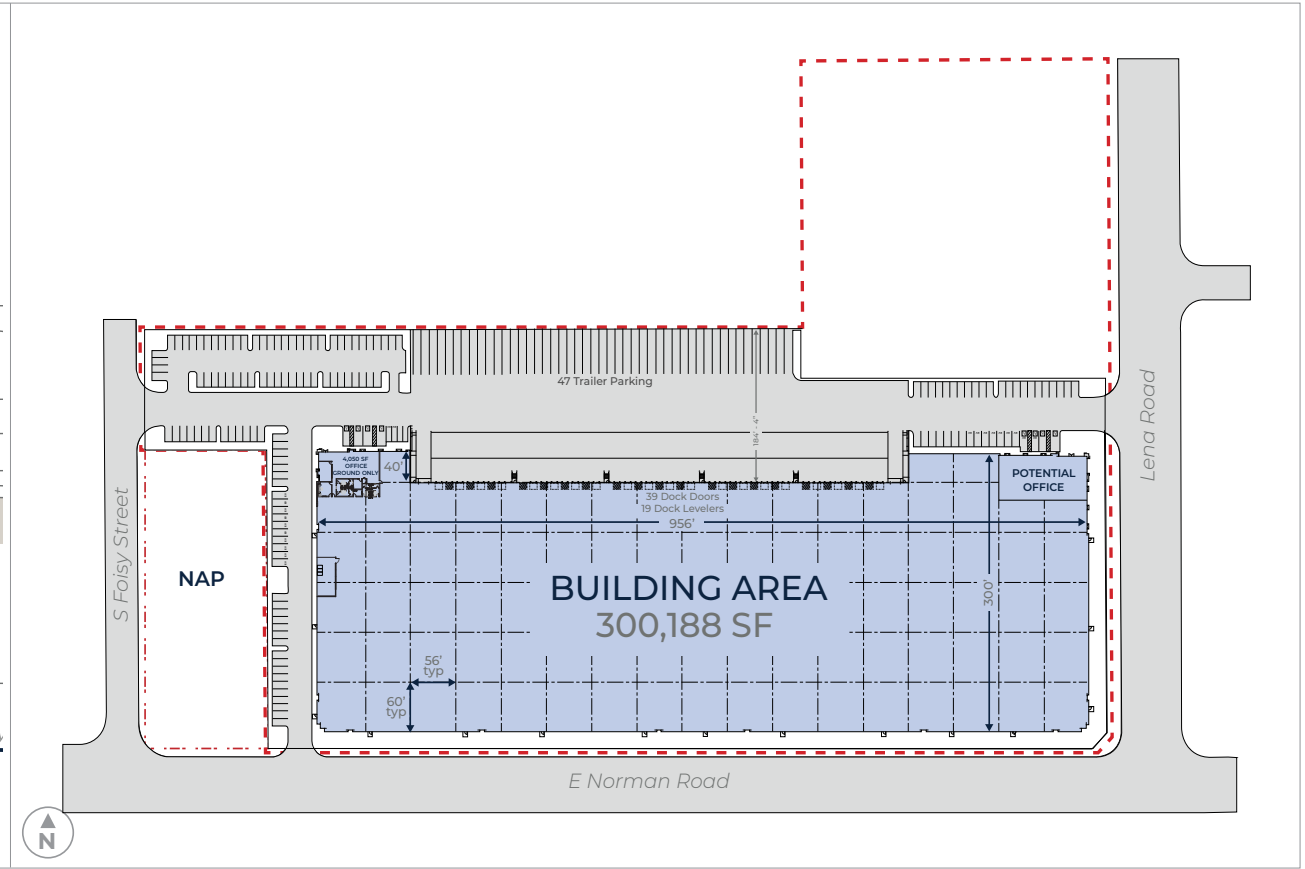
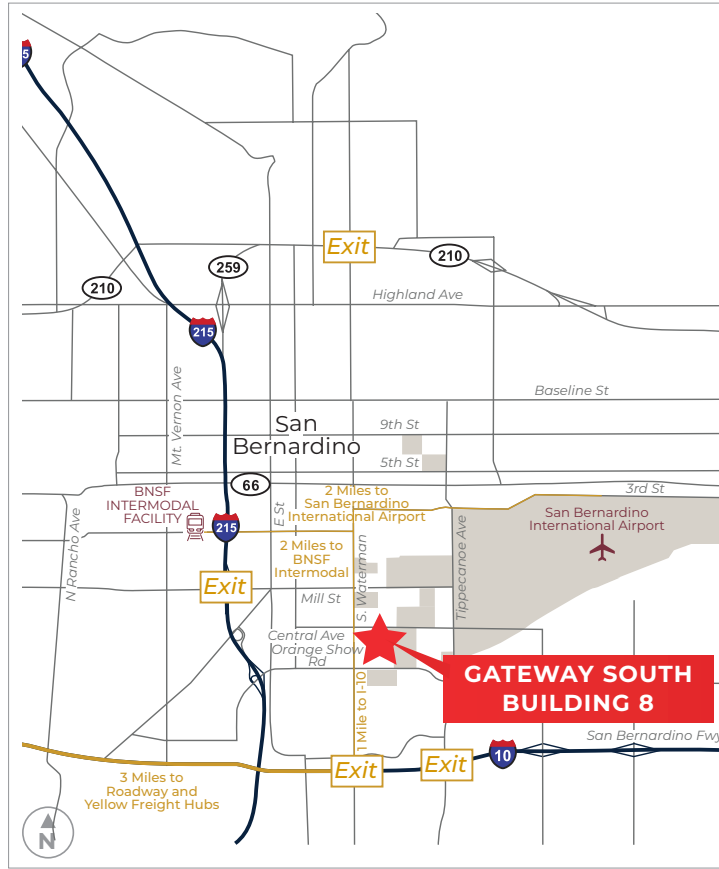

LEED certified



±300,188 SF available on 12 acres



±4,050 SF spec office



36' clear height



185' truck court



159 - auto parking spaces



47 - trailer parking spaces



56' x 60' column spacing;  
60' at staging bays



39 - dock doors



7" thick 4,000 psi concrete slabs



2 - drive-in doors



19 - 35K lb. mechanical dock levelers



30 FC LED speedbay lighting;  
1 FC LED warehouse lighting



2,000 amp service;  
(277/480-volt, 3-phase, 4-wire)



ESFR sprinkler system

Joint Venture Development



SCOTT MORSE

909 380 7292 (o) | 909 214 7899 (c)  
scott.morse@hillwood.com

Leasing



CODY WOLF

909 912 0018 (o) | 909 996 5760 (c)  
cody.wolf@daumcommercial.com





10 MILES

Population



859,606

Median Household  
Income



\$62,120

Labor Force



441,084

### DRIVE TIMES

Interstate 10 & 215



1 mi.



1 min.

San Bernadino International Airport



2 mi.



2 min.

BNSF Intermodal Facility



2 mi.



2 min.

Roadway & Yellow Freight Hubs



3 mi.



5 min.

Ontario International Airport



19 mi.



25 min.

Port of Long Beach



72 mi.



90 min.



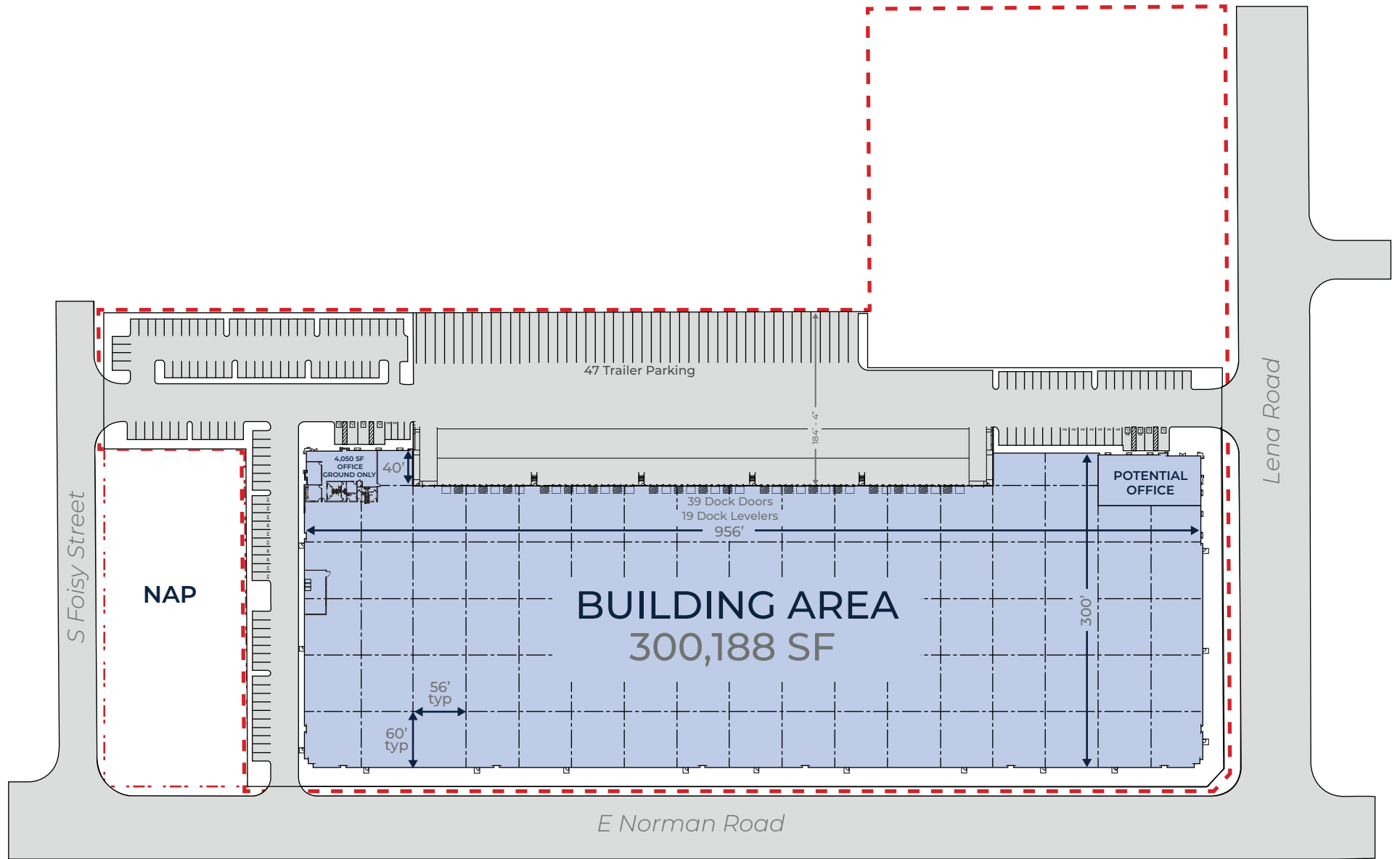



# CONTACT

## JOINT VENTURE DEVELOPMENT



### SCOTT MORSE

909 380 7292 (o) 901 Via Piemonte | Ste 175  
909 214 7899 (c) Ontario, CA 91764  
scott.morse@hillwood.com hillwood.com  
License # 1969110

## LEASING



### CODY WOLF

909 912 0018 (o) 3595 Inland Empire Blvd  
909 996 5760 (c) Building 5  
cody.wolf@daumcommercial.com Ontario, CA 91764  
License # 01997598

This information has been obtained from sources believed reliable, but has not been verified for accuracy or completeness. You should conduct a careful, independent investigation of the property and verify all information. Any reliance on this information is solely at your own risk. Hillwood and the Hillwood logo are service marks of Hillwood. All other marks displayed on this document are the property of their respective owners, and the use of such logos does not imply any affiliation with or endorsement of Hillwood. Photos herein are the property of their respective owners. Use of these images without the express written consent of the owner is prohibited.