

192,896 SF CROSSDOCK FACILITY

1485 S. LILAC AVE. | RIALTO, CA

For More Information, Contact:

GUS ANDROS, SIOR
EXECUTIVE VICE PRESIDENT
P: 909.912.0003 | M: 949.533.3829
gus.andros@daumcommercial.com
CA License #01010235

RICK JOHN, SIOR
EXECUTIVE VICE PRESIDENT
P: 909.912.0001 | F: 909.912.0011
rj@daumcommercial.com
CA License #00800783

DAUM Commercial Real Estate
3595 E. Inland Empire Blvd., Bldg. 5 | Ontario, CA 91764
Phone: 909.980.1234 - Fax: 909.980.3775
www.daumcommercial.com

FOR LEASE | RIALTO INDUSTRIAL CENTER

192,896 SF CROSSDOCK FACILITY

1485 S. LILAC AVE. | RIALTO, CA

PROPERTY HIGHLIGHTS

- Crossdock Loading
- ESFR Fire Protection
- 175' Secured Truck Court
- 31 Trailer Parking Stalls
- ±4,082 SF Total Office Space; 2,041 SF at each Office Pod
- 54 DH Doors (9'x10')
- 2 Grade Level Doors (12'x14')
- 30' Minimum Clearance
- 50'x52' Bay Spacing
- 156 Car Parking
- 2000 AMP 277/480V Capacity (Subject to Verification from Tenant)
- Immediate Interstate 10 Access
- Traffic Signal at Lilac Ave. & Valley Blvd. Installed

Although all information is furnished regarding for sale, rental or financing is from sources deemed reliable, such information has not been verified and no express representation is made nor is any to be implied as to the accuracy thereof, and it is submitted subject to errors, omissions, changes of price, rental or other conditions, prior sale, lease or financing, or withdrawal without notice. D/AQ Corp. # 01129558



FLOOR PLAN

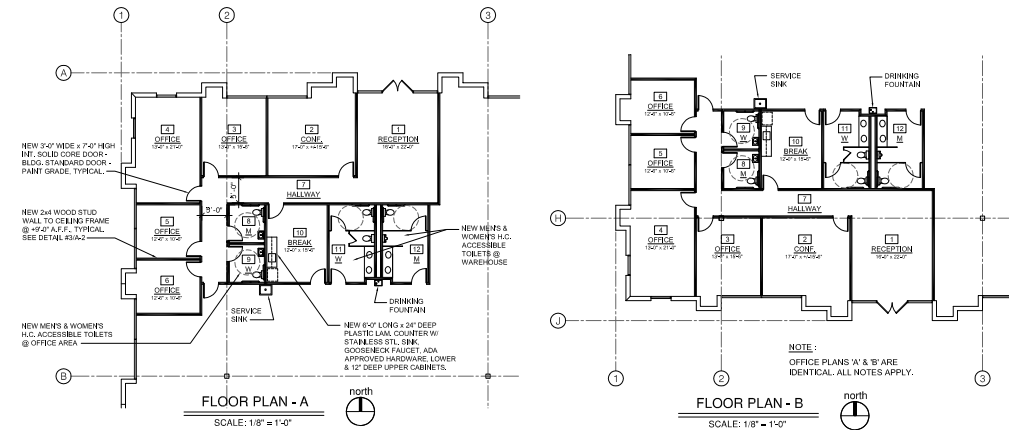

SITE PLAN

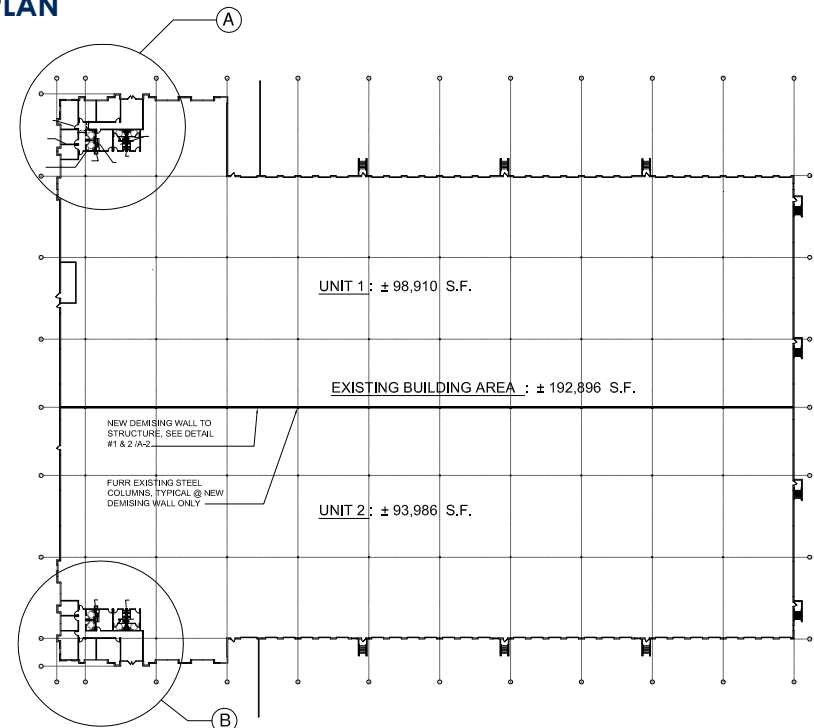

SITE PLAN

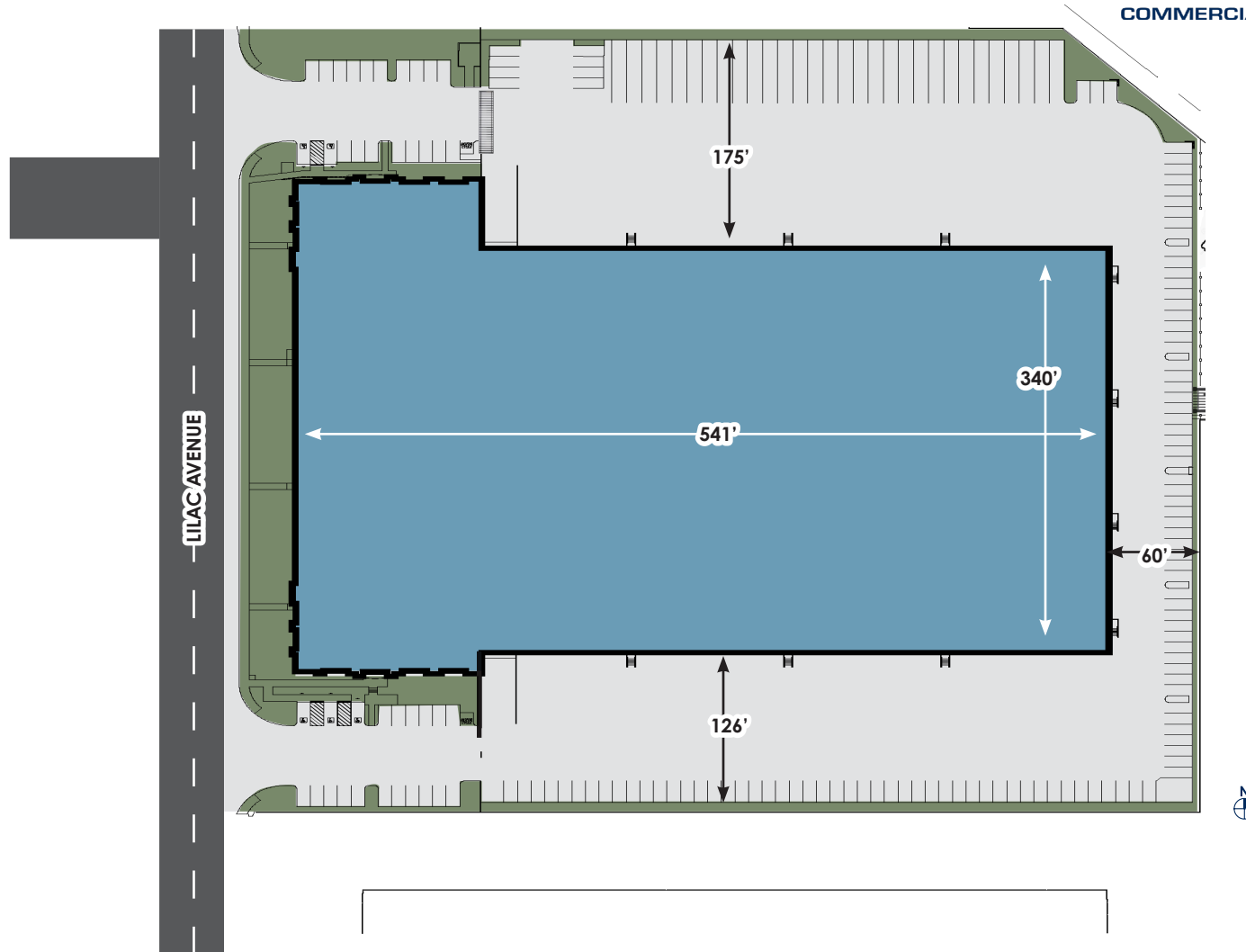

For More Information, Contact:

GUS ANDROS, SIOR
EXECUTIVE VICE PRESIDENT
P: 909.912.0003 | M: 949.533.3829
gus.andros@daumcommercial.com
CA License #01010235

RICK JOHN, SIOR
EXECUTIVE VICE PRESIDENT
P: 909.912.0001 | F: 909.912.0011
rj@daumcommercial.com
CA License #00800783

FOR LEASE | **RIALTO INDUSTRIAL CENTER**

192,896 SF CROSSDOCK FACILITY

1485 S. LILAC AVE. | RIALTO, CA

Although all information is furnished regarding for sale, rental or financing is from sources deemed reliable, such information has not been verified and no express representation is made nor is any to be implied as to the accuracy thereof, and it is submitted subject to errors, omissions, changes of price, rental or other conditions, prior sale, lease or financing, or withdrawal without notice. D/AQ Corp. # 01129558



CALCRAFT CORP.

SUBJECT PROPERTY

WALMART SUPERCENTER

STG LOGISTICS

AUTOZONE

RISE BAKING COMPANY

COLTON GOLF COURSE

I-10 TRUCK STOP

A-AMERICAN SELF STORAGE

UNION PACIFIC RAILROAD

UPRR WEST COLTON
ROUNDHOUSE

UNION PACIFIC LOCOMOTIVE
FACILITY'S

SLOVER AVENUE

SLOVER AVENUE

Google

For More Information, Contact:

GUS ANDROS, SIOR
EXECUTIVE VICE PRESIDENT
P: 909.912.0003 | M: 949.533.3829
gus.andros@daumcommercial.com
CA License #01010235

RICK JOHN, SIOR
EXECUTIVE VICE PRESIDENT
P: 909.912.0001 | F: 909.912.0011
rj@daumcommercial.com
CA License #00800783

FOR LEASE | RIALTO INDUSTRIAL CENTER

192,896 SF CROSSDOCK FACILITY

1485 S. LILAC AVE. | RIALTO, CA

Although all information is furnished regarding for sale, rental or financing is from sources deemed reliable, such information has not been verified and no express representation is made nor is any to be implied as to the accuracy thereof, and it is submitted subject to errors, omissions, changes of price, rental or other conditions, prior sale, lease or financing, or withdrawal without notice. D/AQ Corp. # 01129558

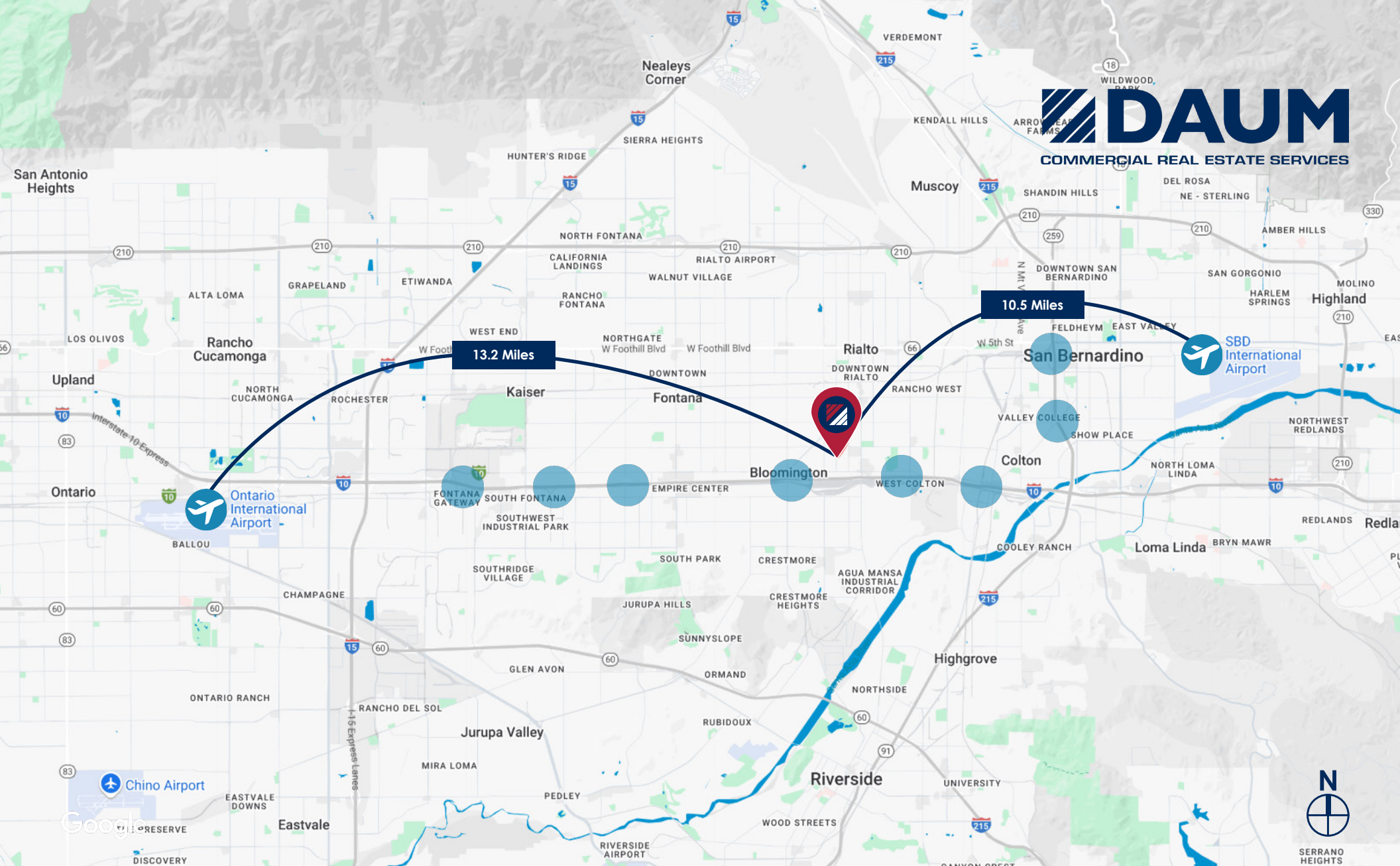

For More Information, Contact:

GUS ANDROS, SIOR
EXECUTIVE VICE PRESIDENT
P: 909.912.0003 | M: 949.533.3829
gus.andros@daumcommercial.com
CA License #01010235

RICK JOHN, SIOR
EXECUTIVE VICE PRESIDENT P:
909.912.0001 | F: 909.912.0011
rj@daumcommercial.com CA
License #00800783

FOR LEASE | RIALTO INDUSTRIAL CENTER

192,896 SF CROSSDOCK FACILITY

1485 S. LILAC AVE. | RIALTO, CA